



GOLDEN

Centrifugal Pumps





CONTENTS

■ Message from CEO	01
■ Profile	02
■ ISO Certification	03
■ GOLDEN Centrifugal Pumps	04
■ Component Detail with Cross Sectional View	06
■ Dimension Table of GOLDEN Centrifugal Pumps (Bare Shaft)	07
■ Performance Curves	08
■ Performance Chart	11
■ Subsidiary Companies	13



Message from CEO:

At GOLDEN PUMPS, we believe that we are ideally placed to cater for your pumping needs whether it is a simple mono pump for your residential usage or specialized 'mid-range' projects such as filling stations or sewage, or 'large-scale' applications in the commercial, agricultural, industrial and public sectors.

With more than 6 decades experience the pump manufacturing industry, GOLDEN PUMPS' engineers are confident that they have both the breadth of knowledge and depth of experience to offer professional services from basic concepts all the way to management of Turn-Key projects & beyond.

We continue to employ highly motivated and capable individuals dedicated to provide solutions that maximize value for our customers. Our people strive to help customers to address their specified needs in a cost effective manner.

The quality of our products, we believe, is the key for the continuous increase in our clientele and thus contributed to the phenomenal growth of our company.

Today's customer demands products that are the latest in technology along with the highest degree of reliability and their durability. That's what you get with GOLDEN PUMPS' cutting-edge product design utilizing the modern technology, rock solid performance and a lifetime convenience.

And when we say " *For Life* ", we mean it.



Profile

GOLDEN PUMPS (PVT) LTD. was established by Haji Ghulam Rasool Mughal (Late) in 1950. Since its inception, the company set the goal of supplying durable and reliable pumping systems to its customers

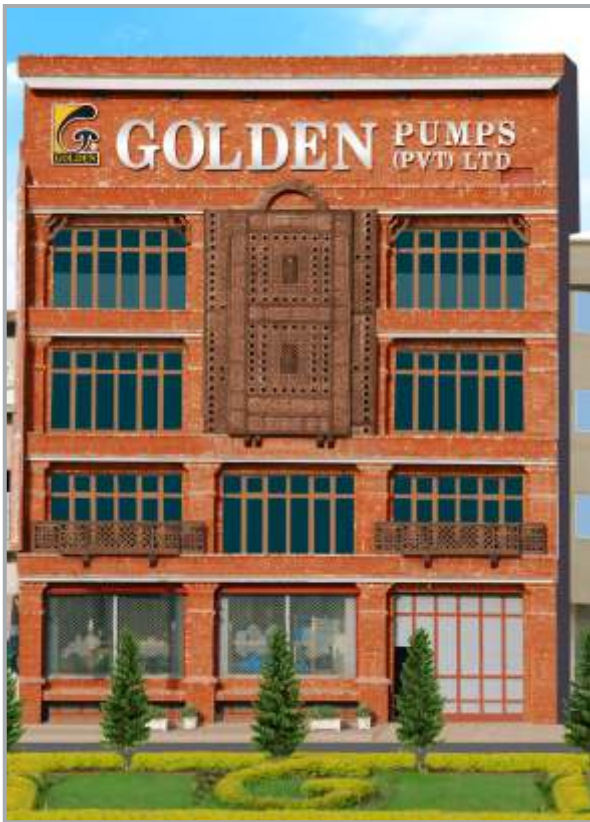

and today no other company, in Pakistan, can compete with GOLDEN PUMPS in its product range and products' performance. This is the result of years of research and sheer hard work of a team with well-experienced, talented engineers and highly skilled and dedicated workers who are always busy not only in maintaining the high standard in production, but also, in search of the best possibilities to enhance the quality. The company firmly believes in serving its customers by giving more than the true value for their money and is determined not to compromise on quality at any cost.

In its four factories (with a covered area of 200,000 sq. ft. approx.) in Gujranwala, the company is committed to produce "top of the range" products including Centrifugal Pumps, Mono-Block Pumps, Non-Clogging (Vertical & Horizontal) Pumps, Multistage Pumps, Reciprocating Positive Displacement Pumps (Piston Pumps), Deep-Well Ejector Pumps (GOLDAMATIC Pumps), Vertical Deep-Well Turbine Pumps, Electric Motors and Diesel Combustion Engines for Industrial, Agricultural and Domestic usages.

Company takes due pride in being the market leader, in our wide product range, setting the industry standards in pump technology. Today GOLDEN PUMPS has become the symbol for quality and reliability in the field of pumping solutions. For over 60 successful years, GOLDEN PUMPS has achieved its success through sheer hard work, consistent quality, research and innovation.

Relishing on its past achievements and its dynamic approach, the company has ventured into the field of 'Enameled Copper Wire' in 1998 with the establishment of "ELECTROTEC INDUSTRIES".

With the help of Chinese Experts "GOLDEN Diesel Engines" (Combustion Engines) were introduced into the product line of the company in 1998. The GOLDEN Diesel Engine is a single cylinder four-stroke, powerful yet compact horizontal type water-cooled diesel engine ideal for commercial and agricultural usage. GOLDEN Diesel engines are available in a wide range of horse-powers capacity.

GOLDEN has also ventured into the production of 'uPVC Pipes' (un-plasticized Polyvinyl Chloride) in 2003 with the brand names of "GOLDAMATIC & MONO-GOLD uPVC Pipes" having a production range from 1" to 14" in Sewage Pipes, Pressure Pipes and Non-Pressure Pipes in Class A, B, C, D & E and Conduit Pipes.

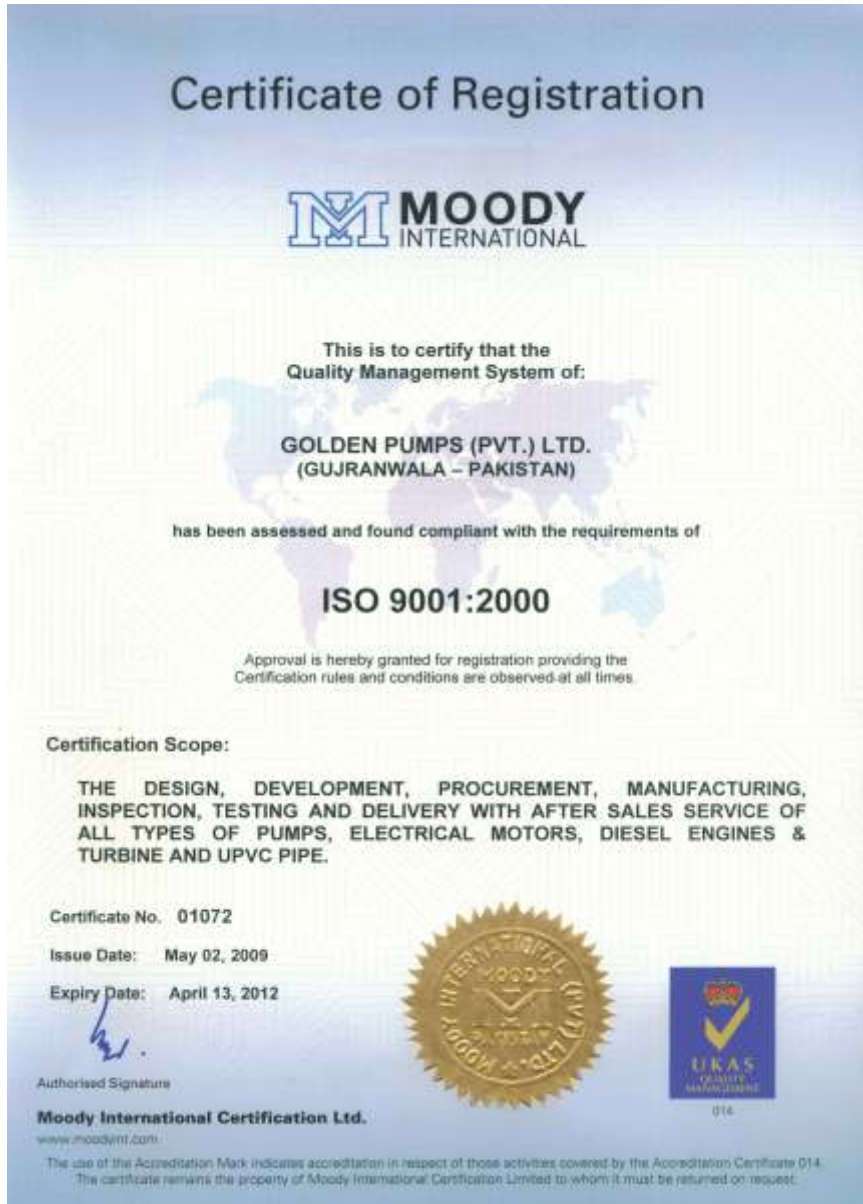

ISO Certification

Company has been awarded the ISO-9000:2000 'QUALITY MANAGEMENT CERTIFICATE'. Besides, it's the leading Pakistani company among pumps, electric motors, diesel engines and upvc pipes manufacturing companies to achieve "ISO-9001:2000 accreditation for designing, development, procurement, manufacturing, inspection, testing and delivery with after-sales service for all types of Pumps, Electric Motors, Deep-Well Turbines, Diesel Engines and uPVC Pipes.

Company would like to thank its valued customers, dealers and suppliers for their continuous support and feedback in all spheres of activities. Company is further improving efficiency to achieve excellence in its cordial customer relationship and ensure moral integrity in its dealings.



GOLDEN Centrifugal Pumps

GCP is a series of Centrifugal Pumps with Radial Type Vanes, Closed Impeller for different delivery heads and pumping capacity. These are Horizontal Single-Stage or Double-Stage End Suction Centrifugal Pumps with solid construction offering continuous reliability, trouble-free service and high performance. These pumps are available with Loose Fast Flat Belt Pulley, V-Belt Pulley and in Bare Shaft models. Bare Shaft Pumps can be fitted with a heavy duty pedestal to give the machine high rigidity necessary for coupling it with Electric Motor. In case where it is not feasible to use Electric Motor, 'GOLDEN Diesel Engine' (Combustion Engine) can also be used as prime mover.

These pumps feature an oversized support with Grease-Lubricated (ZZ) Japanese Ball Bearings for longer life. According to specifications in some Bearing Housings Oil is used while in others Grease is used. Pumps with Mechanical Seals are also available with Stainless Steel Shaft. Similarly, pumps with Soft-Packed Gland Seal are equipped with Stainless Steel or Carbon Steel Shaft according to the customer's demand.

Closed Impellers are used (according to the customer's requirement) of Close Grained Cast Iron, S. G. Iron, Bronze or Stainless Steel, dynamically balanced for smooth running. Similarly, Body and Suction Cover are used (according to the customer's requirement) of Close Grained Cast Iron or Stainless Steel. All other components of the pumps are made of the best suited materials and machined under strict 'Quality Control' supervision to ensure a perfect and longer operating life.

These pumps comprise vast experience acquired both in designing and manufacturing, as well as, in the most common applications, such as, Public or Industrial Water Supply, Construction Sites, Hotels, Fire Fighting Stations, Irrigation, Fresh Water Handling, Hot or Over-Heated Water Circulation in Heating Systems, etc.

The extended model range, the possibility of direct coupling to Electric Motor or 'GOLDEN Diesel Engine' (Combustion Engine) and availability of special construction of 'Mobile Trolley' on demand are enabling offers for each of the different applications, the best solution for dependability, efficiency and energy conservation.

These pumps are not only suitable for clean, chemically and mechanically non-aggressive waters but also designed for a wide range of industrial chemicals.

Bare Shaft Pump



Mono-Block Pump



Loose-Fast Pulley Pump



V-Belt Pulley Pump



Bare-Shaft Pump

coupled with Diesel Engine



Bare-Shaft Pump

coupled with Electric Motor

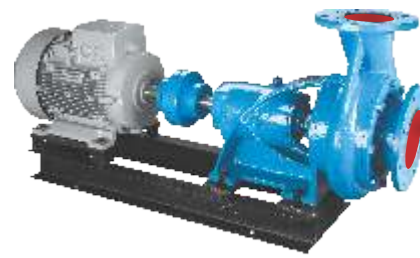

Bare-Shaft Pump

coupled with Diesel Engine on Trolley



V-Belt Pulley Pump

coupled with Diesel Engine on Trolley



GOLDEN Centrifugal Pump

(Cross - Sectional View)

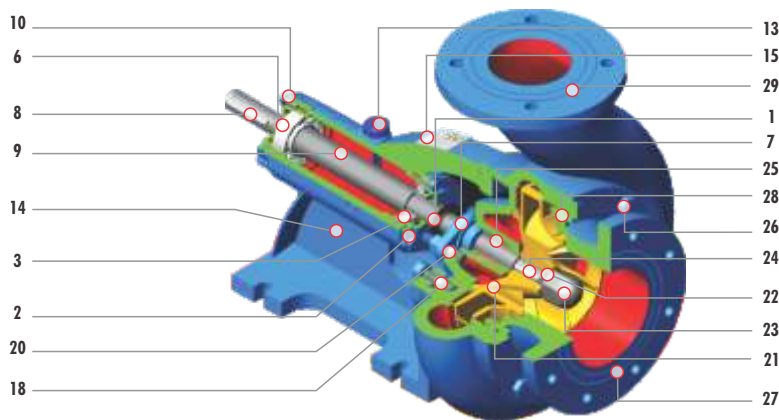
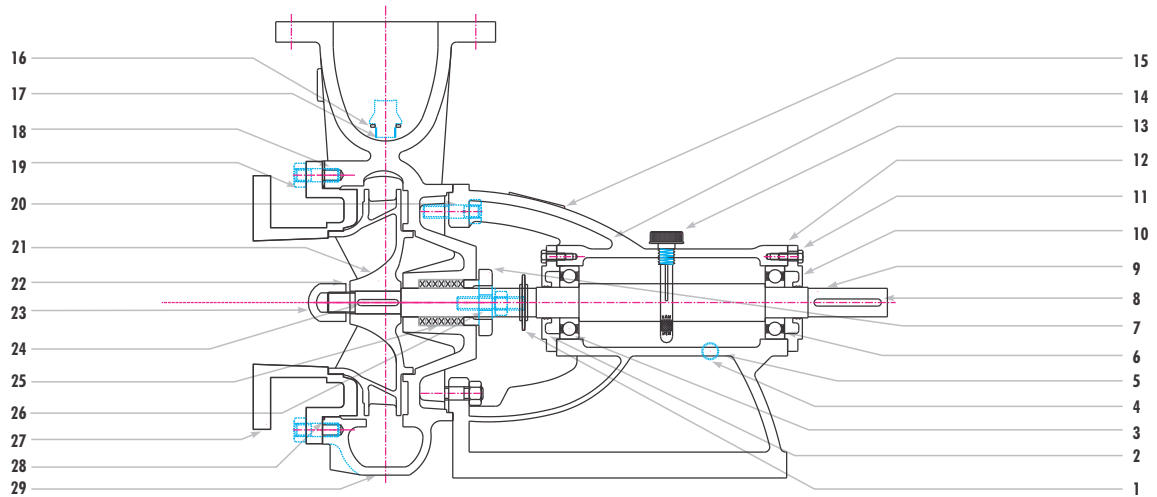

No.	Description	Material
1	Splash Shield	Rubber
2	Bearing Plate (int. side)	Cast Iron
3	Ball Bearing (Pump Side)	Shielded Type - zz
4	O - Ring (Oil Drain Plug)	Mild Steel
5	Oil Drain Plug	Mild Steel
6	Ball Bearing (Drive Side)	Shielded Type - zz
7	Gland Plate	Cast Iron / Bronze
8	Key Coupling / Pulley	Mild Steel
9	Shaft	Carbon Steel / S. Steel
10	Bearing Plate (ext. side)	Cast Iron
11	Bolt	Mild Steel
12	Gasket	Paper
13	Oil Gauge	Plastic
14	Bearing Housing	Cast Iron
15	Name Plate	Mild Steel

No.	Description	Material
16	O - Ring (Prime Plug)	Rubber
17	Prime Plug	Mild Steel
18	Stud 2 (Bearing Housing)	Mild Steel
19	Nut	Mild Steel
20	Stud 3 (Gland Plate)	Mild Steel
21	Impeller	Cast Iron / Bronze / S. Steel
22	Spring Washer	Mild Steel
23	Impeller Nut	Cast Iron / S. Steel
24	Key 1 (Impeller)	Mild Steel
25	Stuffing Box	Gland Packing / Mech. Seal
26	Stud 1 (Suction Cover)	Mild Steel
27	Suction Cover	Cast Iron / S. Steel
28	O - Ring (Suction Cover)	Rubber
29	Volute Casing	Cast Iron / S. Steel

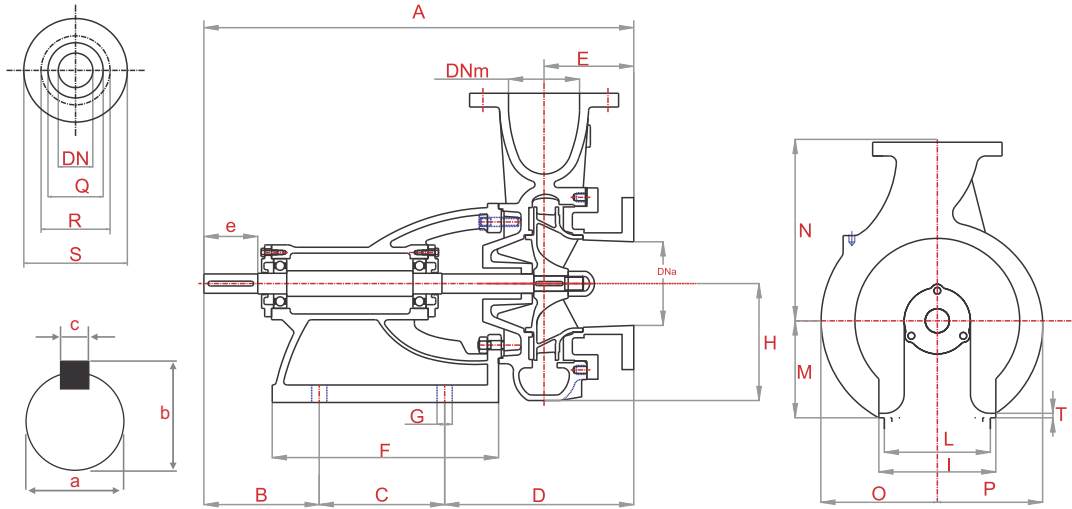

Dimension Table of GOLDEN Centrifugal Pumps (Bare Shaft)

Items #	Model	Size	Bearing	DNa	DNm	mm															Shaft Projection	Weight 'kg'
						A	B	C	D	E	F	G	H	I	L	M	N	O	P	T		
1	GCP 40-21	2" x 1.5"	6206	50	40	550	130	190	230	114	280	18	140	175	125	160	195	140	140	20	1	52
2	GCP 50-17	2.5" x 2"	6206	65	50	605	130	190	285	112	280	18	128	175	125	160	176	130	120	20	1	46
3	GCP 50-24	2.5" x 2"	6306	65	50	600	140	244	216	114	330	16	160	205	165	170	242	160	157	20	2	67
4	GCP 65-22	3" x 2.5"	6206	75	65	580	130	190	260	112	280	18	150	175	125	160	230	160	142	20	1	57
5	GCP 65-27	3" x 2.5"	6306	80	65	610	140	244	226	122	330	16	204	205	165	170	300	210	185	20	2	84
6	GCP 80-22	4" x 3"	6306	100	80	606	140	244	222	120	330	16	162	205	165	170	250	168	155	20	2	68
7	GCP 80-70	4" x 3"	6306	100	80	610	140	244	226	130	330	16	205	205	165	170	300	210	185	20	2	84
8	GCP 80-31	4" x 3"	6408	100	80	664	175	238	251	175	335	20	218	205	165	196	316	224	201	20	3	108
9	GCP 100-22	5" x 4"	6306	125	100	610	140	244	226	118	330	16	170	205	165	170	279	194	163	20	2	72
10	GCP 100-27	5" x 4"	6408	125	100	680	175	238	267	145	335	20	208	205	165	196	300	215	178	20	3	105
11	GCP 100-33	5" x 4"	6408	125	100	683	175	238	270	140	335	20	230	205	165	196	382	240	218	20	3	132
12	GCP 125-24	6" x 5"	6408	150	125	690	175	238	278	150	335	20	200	205	165	196	306	215	170	20	3	103
13	GCP 125-27	6" x 5"	6408	150	125	695	175	238	282	152	335	20	222	205	165	196	342	240	204	20	3	121
14	GCP 150-27-6	6" x 6"	6408	150	150	700	175	238	287	150	335	20	215	205	165	196	256	237	193	20	3	119
15	GCP 150-27	7" x 6"	6408	175	150	713	175	238	300	174	335	20	215	205	165	196	256	237	193	20	3	125

Shaft Projection

Type	a	b	c	e
	mm			
1	97	135	4	15
2	115	164	4	15
3	125	169	4	15

Flanges

Port ø	R	S	Holes	
	ø mm		No.	ø mm
40	97	135	4	15
50	115	164	4	15
65	125	169	4	15
80	146	188	4	15
100	177	225	4	15
125	208	250	8	15
150	274	232	8	15



GOLDEN Centrifugal Pumps

GCP 40-21-205 (2" x 1.5") / 2 HP / 1450 rpm
 GCP 50-17-170 (2.5" x 2") / 2 HP / 1450 rpm

GCP 50-24-215 (2.5" x 2") / 3 HP / 1450 rpm
 GCP 50-24-240 (2.5" x 2") / 5 HP / 1450 rpm

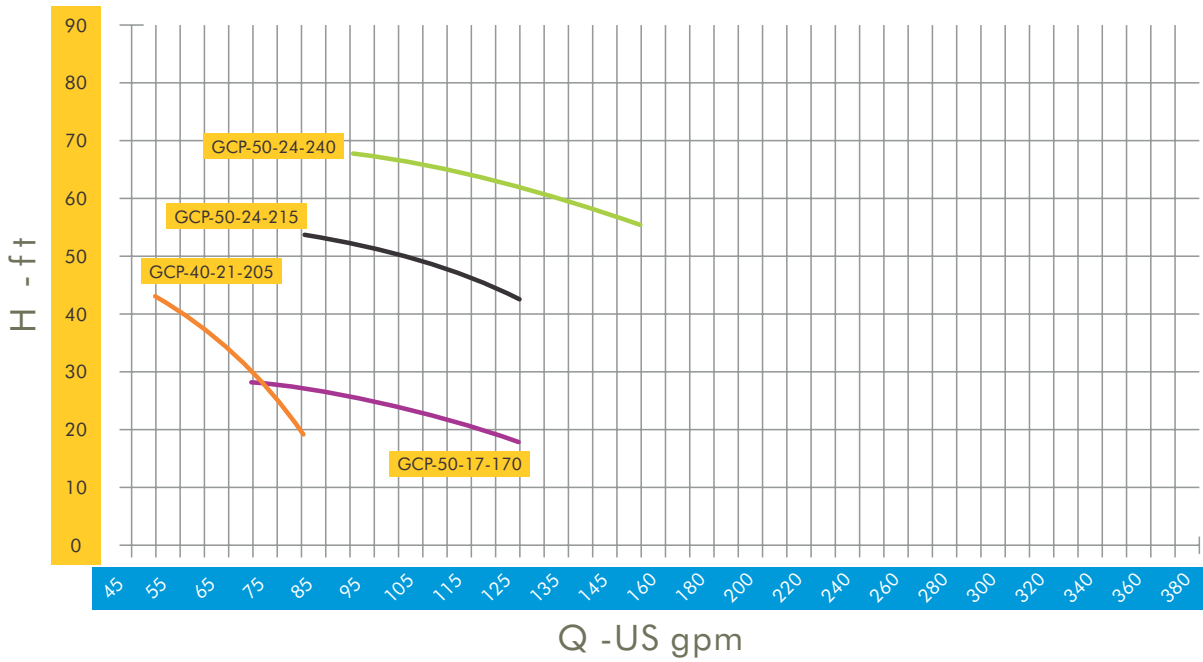

GCP 65-22-155 (3" x 2.5") / 3 HP / 1450 rpm
 GCP 65-22-217 (3" x 2.5") / 5 HP / 1450 rpm

GCP 65-27-255 (3" x 2.5") / 7.5 HP / 1450 rpm
 GCP 65-27-270 (3" x 2.5") / 10 HP / 1450 rpm

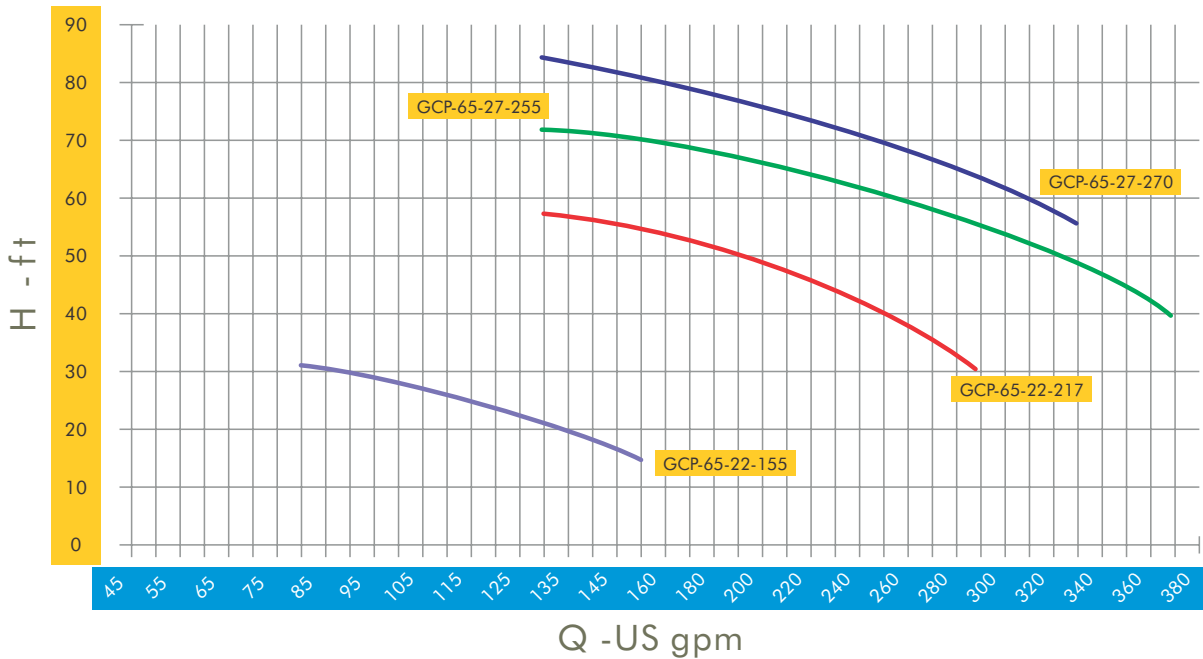



GOLDEN Centrifugal Pumps

GCP 80-22-170 (4" x 3") / 3 HP / 1450 rpm
 GCP 80-22-200 (4" x 3") / 5 HP / 1450 rpm
 GCP 80-22-222 (4" x 3") / 7.5 HP / 1450 rpm
 GCP 80-27-245 (4" x 3") / 7.5 HP / 1450 rpm

GCP 80-27-265 (4" x 3") / 10 HP / 1450 rpm
 GCP 80-31-270 (4" x 3") / 10 HP / 1450 rpm
 GCP 80-31-210 (4" x 3") / 15 HP / 1450 rpm

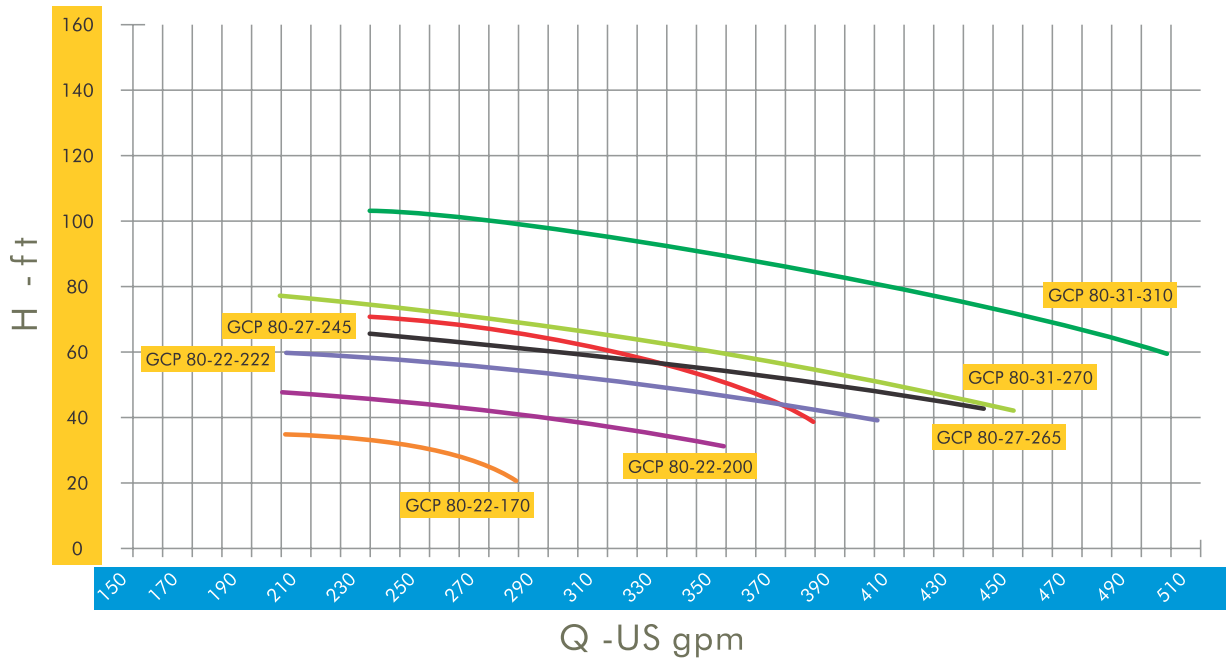

GCP 100-22-180 (5" x 4") / 5 HP / 1450 rpm
 GCP 100-22-195 (5" x 4") / 7.5 HP / 1450 rpm
 GCP 100-22-212 (5" x 4") / 10 HP / 1450 rpm
 GCP 100-27-230 (5" x 4") / 10 HP / 1450 rpm

GCP 100-27-265 (5" x 4") / 15 HP / 1450 rpm
 GCP 100-33-305 (5" x 4") / 20 HP / 1450 rpm
 GCP 100-33-333 (5" x 4") / 55 HP / 1450 rpm

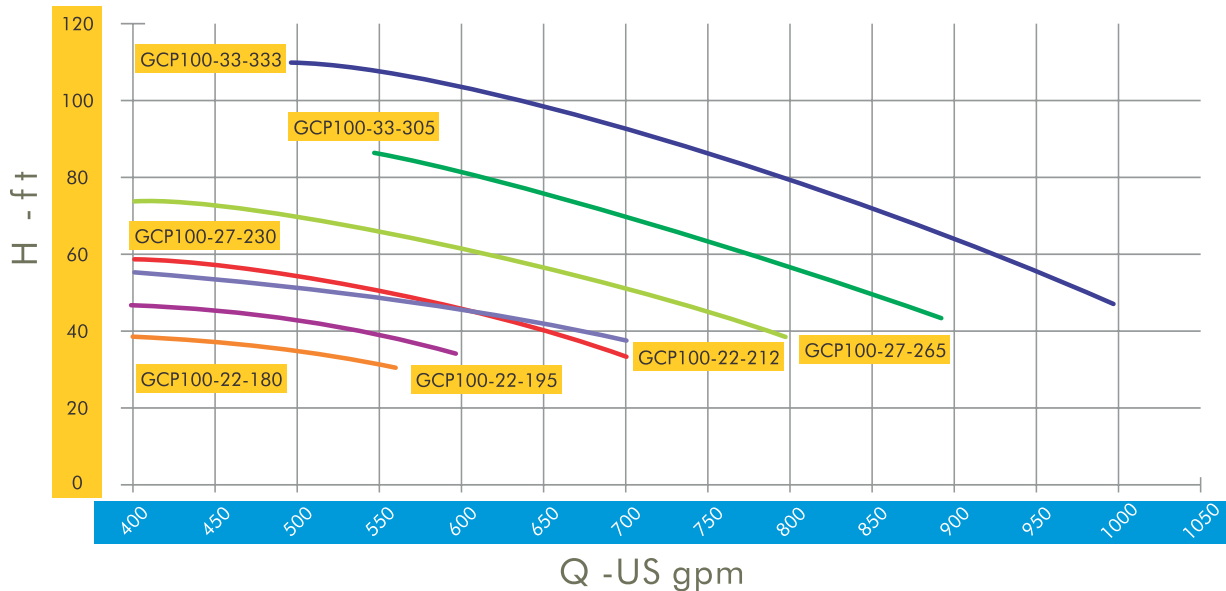



GOLDEN Centrifugal Pumps

GCP 125-24-205 (6" x 5") / 10 HP / 1450 rpm
 GCP 125-24-230 (6" x 5") / 15 HP / 1450 rpm
 GCP 125-24-242 (6" x 5") / 20 HP / 1450 rpm

GCP 125-27-250 (6" x 5") / 20 HP / 1450 rpm
 GCP 125-27-265 (6" x 5") / 25 HP / 1450 rpm

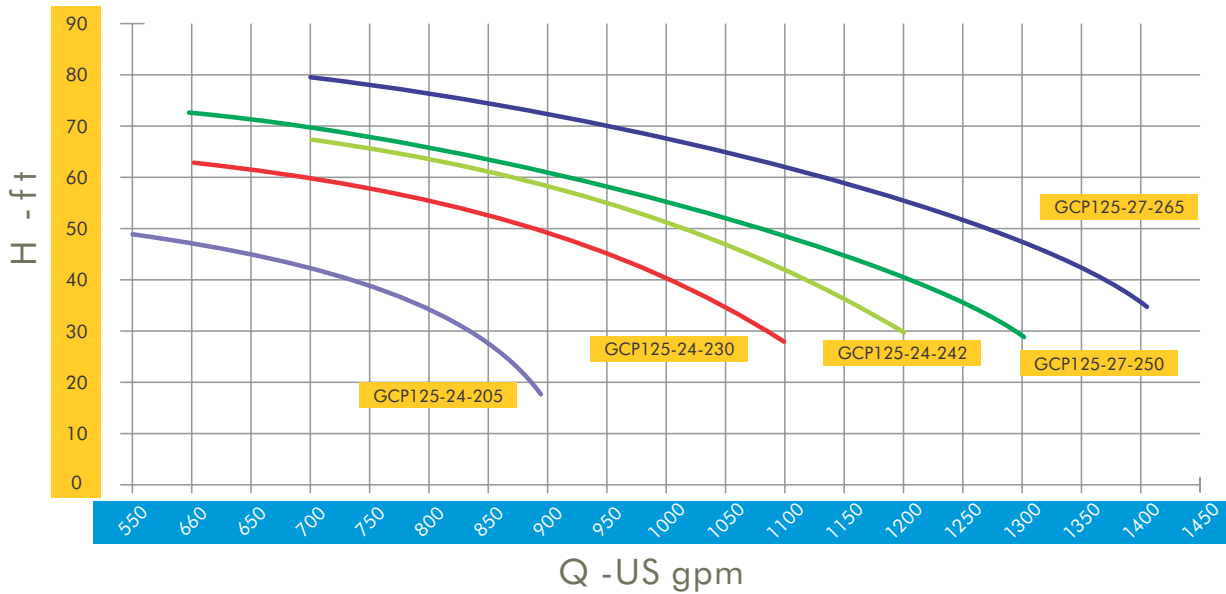

GCP 150-27-6-225 (6" x 6") / 20 HP / 1450 rpm
 GCP 150-27-6-245 (6" x 6") / 25 HP / 1450 rpm
 GCP 150-27-6-260 (6" x 6") / 30 HP / 1450 rpm

GCP 150-27-245 (7" x 6") / 20 HP / 1450 rpm
 GCP 150-27-265 (7" x 6") / 25 HP / 1450 rpm
 GCP 150-27-270 (7" x 6") / 30 HP / 1450 rpm

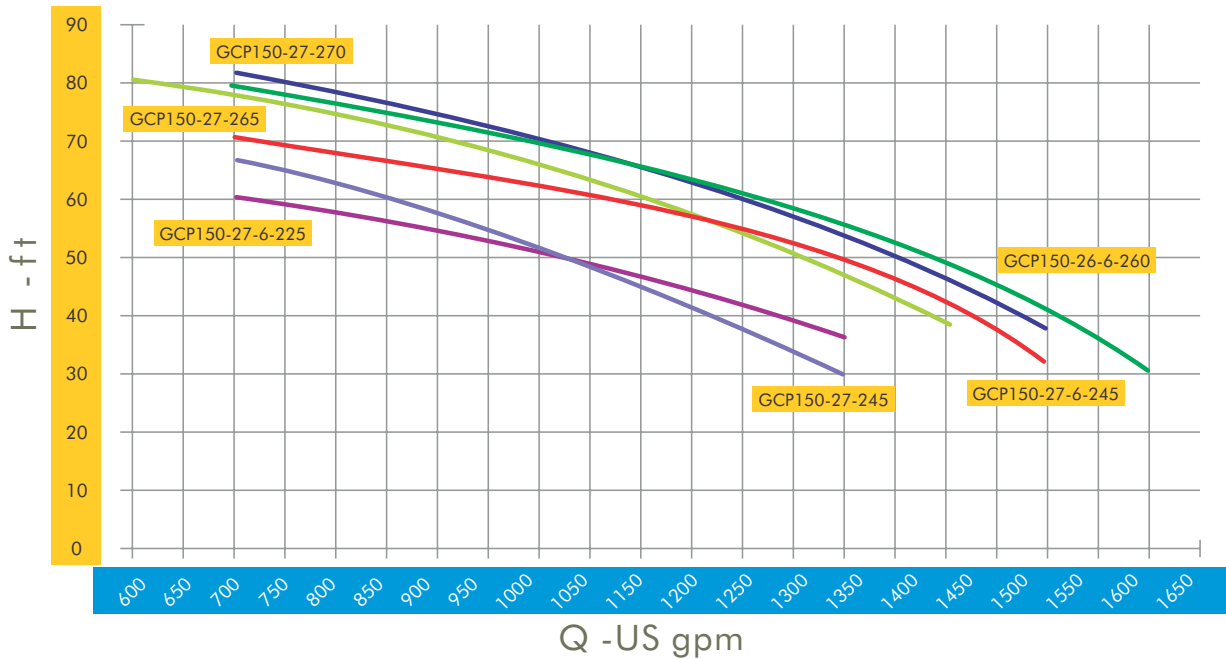



Item #	Model	Size	Motor HP	Impeller Dia (mm)	Q = Capacity (US gpm - l/min)														
					50	60	70	80	90	100	110	120	130	140	150	160	170	180	
					189	227	265	303	341	379	416	454	492	530	568	606	644	681	
1	GCP 40-21	2" x 1.5"	2	205	43	48	30	19											
2	GCP 50-17	2.5" x 2"	2	170			28	27	25	23	21	19							
3	GCP 50-24	2.5" x 2"	3	215				54	52	50	47	44							
4			5	240					68	66	64	62	60	58	56				
5	GCP 65-22	3" x 2.5"	3	155				31	29	27	25	23	20	18	15				
6			5	217										57	56	55	54	53	52
7	GCP 65-27	3" x 2.5"	7.5	255										72	71	70	69	69	68
8			10	270											85	83	81	80	79

Item #	Model	Size	Motor HP	Impeller Dia (mm)	Q = Capacity (US gpm - l/min)													
					150	160	170	180	190	200	210	220	230	240	250	260	270	280
					568	606	644	681	719	757	795	833	871	908	946	984	1022	1060
1	GCP 80-22	4" x 3"	3	170						35	35	34	33	31	30	28	25	21
2			5	200						48	47	47	46	45	44	42	41	40
3			7.5	222						60	60	59	58	57	56	56	55	54
4	GCP 80-27	4" x 3"	7.5	245									66	65	64	63	62	61
5			10	265										71	70	69	68	66
6	GCP 80-31	4" x 3"	10	270						77	76	75	74	73	71	70	69	68
7			15	310										103	102	101	100	99

Item #	Model	Size	Motor HP	Impeller Dia (mm)	Q = Capacity (US gpm - l/min)															
					400	450	500	550	600	650	700	750	800	850	900	950	1000			
					1514	1703	1893	2082	2271	2461	2650	2839	3028	3218	3407	3596	3785			
					H = Total Head (ft) @ 1450 rpm															
1	GCP 100-22	5" x 4"	5	180	28	37	34	31												
2			7.5	195	46	44	42	38	34											
3			10	212	55	53	51	48	45	14	38									
4	GCP 100-27	5" x 4"	10	230	58	56	53	49	45	40	34									
5			15	265	73	72	69	66	62	57	51	45	39							
6	GCP 100-33	5" x 4"	20	305				86	81	75	75	62	56	49	43					
7			25	333			110	107	103	98	98	85	78	70	63	54	46			

Item #	Model	Size	Motor HP	Impeller Dia (mm)	Q = Capacity (US gpm - l/min)																
					550	600	650	700	750	800	850	900	950	1000	1050	1100	1150	1200			
					2082	2271	2461	2650	2839	3028	3218	3407	3596	3785	3975	4164	4353	4542			
					H = Total Head (ft) @ 1450 rpm																
1	GCP 125-24	6" x 5"	10	205	49	47	45	42	39	35	27	17									
2			15	230		63	62	60	58	56	52	49	45	40	35	28					
3			20	242				67	65	63	60	58	55	52	47	42	36	29			
4	GCP 125-27	6" x 5"	20	250		73	72	70	68	66	64	61	59	56	52	49	45	40			
5			25	265				80	79	77	75	73	71	68	65	62	59	55			

Item #	Model	Size	Motor HP	Impeller Dia (mm)	Q = Capacity (US gpm - l/min)															
					600	650	700	750	800	850	900	950	1000	1050	1100	1150	1200	1250		
					2271	2461	2650	2839	3028	3218	3407	3596	3785	3975	4164	4353	4542	4732		
					H = Total Head (ft) @ 1450 rpm															
1	GCP 150-27-6	6" x 6"	20	225			61	60	58	57	55	53	51	49	47	45	43	40		
2			25	245			70	69	67	66	64	63	61	60	58	56	54	52		
3			30	260			79	78	76	75	73	71	69	67	65	63	61	59		
4	GCP 150-27	7" x 6"	20	245			67	65	63	61	58	55	52	49	45	42	38	34		
5			25	265	81	80	78	77	75	73	71	69	66	63	60	57	53	50		
6			30	270			82	81	79	77	75	73	70	68	65	62	59	56		



Q = Capacity (US gpm - l/min)																		
190	200	210	220	230	240	250	260	270	280	290	300	310	320	330	340	350	360	370
719	757	795	833	871	908	946	984	1022	1060	1098	1136	1173	1211	1249	1287	1325	1363	1401
H = Total Head (ft) @ 1450 rpm																		
50	49	48	46	44	42	40	38	36	33	30								
66	65	64	63	62	61	60	59	57	56	55	53	52	50	49	47	45	43	40
77	76	75	74	72	71	70	68	67	65	64	62	60	59	56				

Q = Capacity (US gpm - l/min)																					
290	300	310	320	330	340	350	360	370	380	390	400	410	420	430	440	450	460	470	480	490	500
1098	1136	1173	1211	1249	1287	1325	1363	1401	1438	1476	1514	1552	1590	1628	1666	1703	1741	1779	1817	1855	1893
H = Total Head (ft) @ 1450 rpm																					
39	37	36	35	34	33	31															
53	52	50	49	48	47	46	44	43	42	41	39										
60	59	59	58	57	56	55	54	53	52	50	49	47	46	45	43	42					
64	62	60	59	57	54	51	47	43	39												
67	66	64	63	62	61	60	58	57	55	53	52	50	48	46	44	42					
96	95	94	93	92	90	89	87	86	84	82	80	78	76	74	72	70	68	65	63	61	59

1250	1300	1350	1400
4732	4921	5110	5300
35	30		
51	47	42	35

1300	1350	1400	1450	1500	1550	1600
4921	5110	5300	5489	5678	5867	6057
37						
49	45	41	36	31		
56	53	50	46	41	36	30
30						
47	43	39				
53	50	46	42	37		



Subsidiary Companies

ELECTROTEC INDUSTRIES:

Building upon its past successes and its progressive approach, the Company has ventured into the manufacturing of 'Enameled Copper Wire' in 1998 with the establishment of "ELECTROTEC INDUSTRIES".

Due to premium quality and a strong backing by a team of qualified experts, Voltiger brand has become extremely popular among the big and small, public and private sector units generating a long list of satisfied customers to its credit in a short span of period. Rigorous quality control from raw material to finished product ensures much higher ratings than the prescribed norms of PAKISTAN and B.S.S. specifications with the result that today 'Voltiger' brand enameled copper wire stands distinct in the market for its reliability, performance and above all safe-guarding the interest of the customers due to its close interaction.

At "ELECTROTEC INDUSTRIES" the emphasis is on quality control. An enameled wire consists of two major components i.e. 'Copper Conductor' and 'Enamel / Insulating Film'.

- 1. Copper Conductor:** "ELECTROTEC INDUSTRIES" is very meticulous about the purity of copper conductor, only 99.9% pure 'Electrolytic' grade 'A' continuous Cast Copper Rods (conforming to ASTM/B-49/78 manufactured by 'Pakistan Cables Ltd.' and 'Bawany Metals Ltd.') is used to ensure the softness and flexibility with least resistance in wire.
- 2. Enamel / Insulating Film:** 'Enameled Copper Wire' is manufactured with super grade enamel which imparts dielectric strength and insulates against moisture and corrosion. The company has a very stringent Q.C. process with a wide range of different specifications to be met with all the standards and the final product is released only when it passes through the specified results of S.S. and ICS standards stretching in fact with higher values of standards.

Product Range: Company's range of production is from 10 SWG (3.25 mm) to 35 SWG (0.213 mm) in fine (Grade-I), Medium (Grade-II), Thick (Grade-III) and Extra Thick covering.

GOLDEN POLYTECH (PVT) LTD.

Capitalizing on its past successes and its progressive approach, GOLDEN PUMPS (PVT) LTD. has ventured into the 'uPVC Pipes (un-plasticized Polyvinyl Chloride)' with the brand name of 'Goldamatic uPVC Pipes'. Due to the best available manufacturing facilities and use of the top quality virgin raw material, company is able to provide the following distinctive advantages:

- Total resistance to corrosion, abrasion, growth of bacteria and fungus
- Light weight, durable and economical



- Simple to join and quick to install
- Flexible and resistance to breakage
- Easy to transport
- Non-toxic and non-conductive
- Smooth bore provides low frictional losses and high flow capabilities
- Non-flammable

These pipes are widely used for transferring of cold water supply & waste water in different applications i.e., construction, housing societies, water supply schemes, green-house irrigation, deep-well turbines, tube wells, deep-well ejector pumps and cable ducting etc.

Product Range: Company's range of production is from 1" to 14" in Sewage Pipes, Pressure Pipes and Non-Pressure Pipes in Class A, B, C, D & E and Conduit Pipes.

Note:

As we are constantly endeavoring to improve the performance of our products we reserve the right to make alteration in our products from time to time, and actual product may differ from that detail mentioned in this brochure.

GOLDEN Group of Companies

GOLDEN PUMPS (PVT) LTD.
G. T. Road, Gujranwala, Pakistan
Tel: +92 55 3842756, 3843756, 4275656
Fax: +92 55 3253254
E-mail: info@goldenpumps.com
Website: www.goldenpumps.com

ELECTROTEC INDUSTRIES
Climaxabad, G. T. Road, Gujranwala, Pakistan
Tel: +92 55 3730789, 3857621, 3857622
Fax: +92 55 3253254
E-mail: info@goldenpumps.com
Website: www.goldenpumps.com



GOLDEN POLYTECH (PVT) LTD.
G. T. Road, Gujranwala, Pakistan
Tel: +92 55 4275655, 4000993
Fax: +92 55 4272455
E-mail: upvc@goldenpumps.com
Website: www.goldenpumps.com